

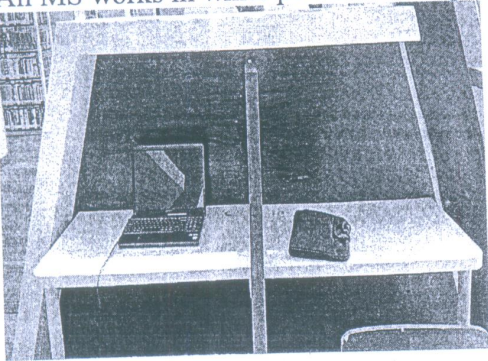

3. BILL OF QUANTITY

S. #	Description	Quantity	Rates	Amount(Rupees)
1(a)	Study Carrel Study Carrel – QTY 2 (Ground Floor for 4 person each) Size = 3'-10" x 5'-8" Manufacturing and providing Study Carrel consist of MDF with oak ply pressed on both sides with approved polish finish, Partition wall in MDF boxing and corian band over MDF boxing having provision of lights & fixing. 4 no. of down lights and 4 no. of Technology Boxes with wiring as per approved manufacturer 4 flat pin power, 4 no. power button for lights & 4 network node (outlets). All MS works in white powder coating. 	2	95600	191200/-
1(b)	Study Carrel – QTY 2 (first Floor for 1 person) Size 2'-0 x 4'-6" Manufacturing and providing Study Carrel consist of MDF with oak ply pressed on both sides with approved polish finish, partition wall in MDF boxing, MDF boxing having provision of lights & fixing. 1 no. of Technology Box with wiring as per approved manufacturer 1 flat pin power outlet & 1 no. network outlet. All MS works in white powder coating. 	2	49500	99000/-

MEMBER
CENTRAL PURCHASE COMMITTEE
INSTITUTE OF BUSINESS ADMINISTRATION
KARACHI
Sayed Akbar Kasim
Finance, IBA Karachi

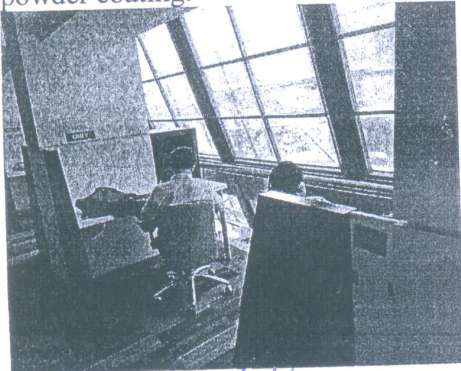
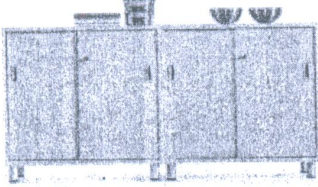
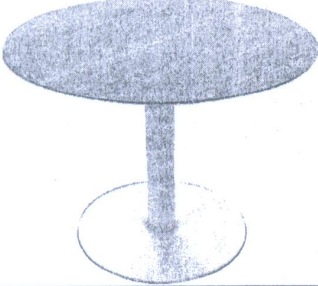

2	Filling Cabinet Master Offisys MO-SLH 09 (Laminate 7600 - White) or equivalent Measurements: L6' x D1'-3" x H 2' - 10" 	1	28500	28500/-
3	Meeting Table Master Offisys Laminate 7600 or equivalent Ch-F/M with Imported Leg 	2	21500	43000/-
4	Cafeteria Chair Colour: Blue, Mango, Grey, Olive Interwood Dexture Chair or equivalent Material: Plastic shell with metal frame Finishing: Powder Coating Seat Height: 440mm Size: mm530W x 550D x 815 H Tube: 25mm dia * 1.2mm thickness SKU: EF-A01 - RD-43752 SAP CODE FG060000022 As Picture 	8	8200	65600



CENTRAL PURCHASE COMMITTEE
INSTITUTE OF BUSINESS ADMINISTRATION
KARACHI
Syed Akbar Kazmi
Finance
IBA, Karachi



5(a)

Kitchen Cabinet 7'-0" x 2'-0" (area- 14)

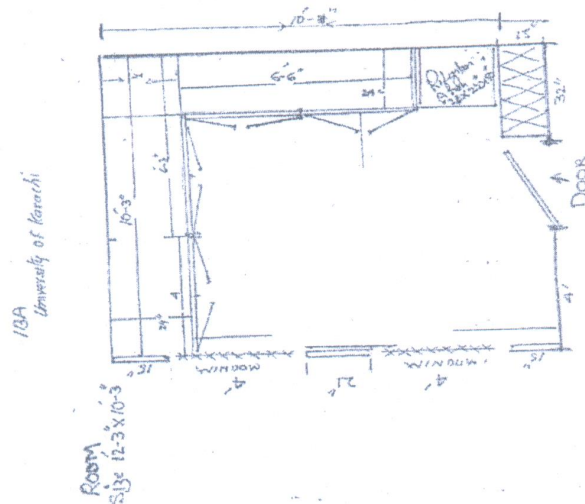
Manufacturing and providing Kitchen Cabinet consist of MDF lamination & PVC lipping of approved colour, complete in all aspects.

**Kitchen Cabinet 7'-0" x 3'-0" (area- 21)**

Manufacturing and providing Kitchen Cabinet consist of MDF lamination & PVC lipping of approved colour, complete in all aspects.

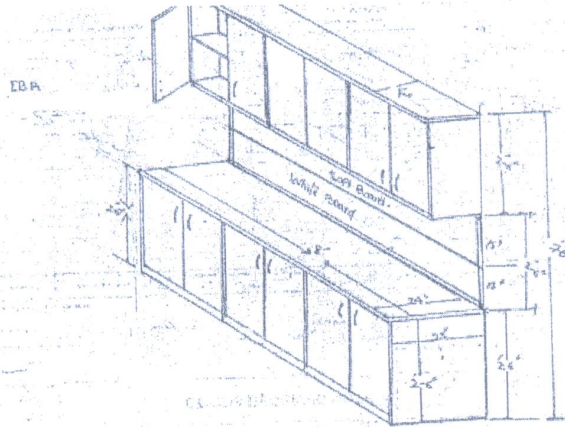

1

28500

28500

1

43500

43500/

MEMBER EXTERNAL
CENTRAL PURCHASE COMMITTEE
INSTITUTE OF BUSINESS ADMINISTRATION
KARACHI

Hassan Gharoon
HES

M. Nadeem Khan
Admin Officer

CHAIRPERSON
CENTRAL PURCHASE COMMITTEE
INSTITUTE OF BUSINESS ADMINISTRATION
KARACHI

Dr. S. M. Faizul
IBA, Karachi

MEMBER
CENTRAL PURCHASE COMMITTEE
INSTITUTE OF BUSINESS ADMINISTRATION
KARACHI

Dr. Waqar Zaidi
& Manager IBA, Karachi

MEMBER
CENTRAL PURCHASE COMMITTEE
INSTITUTE OF BUSINESS ADMINISTRATION
KARACHI

Javed Akbar Kazmi
IBA, Karachi

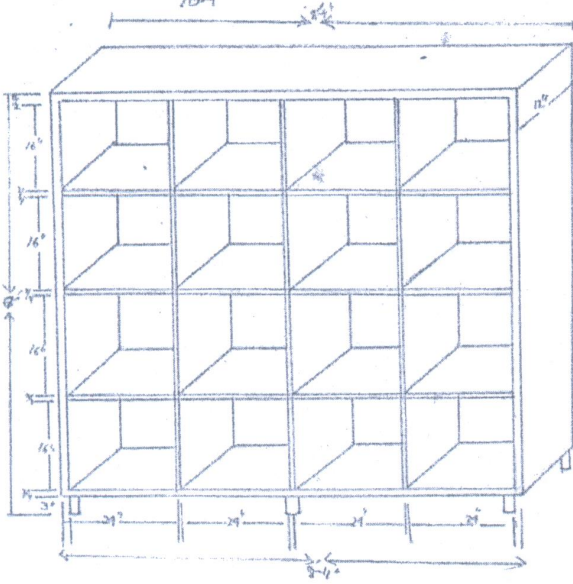
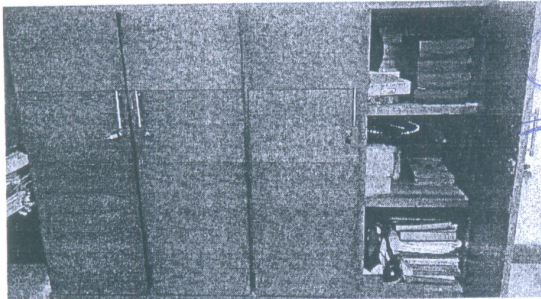
5(b)	<p>KITCHEN SHELVES 8'-0" X 10'-0" (Area -80) Manufacturing and providing shelves consist of MDF lamination & PVC lipping of approved colour with SS Base, complete in all aspects.</p> 	1	81500	81500
6	<p>Filing Cabinet 8'-0" x 5'-2" (area 41.36) Manufacturing and providing Filing Cabinet consist of white MDF lamination with approved colour, complete in all aspects.</p> <p>Colour: White MDF Width 5 feet height 8 feet depth 1.6 feet No. of coloum: 3, No. of Rows: 4 (each shelf height: 2ft each)</p> 	1	56500	56500
7	<p>Lockers front shutter with lock, ground floor (area - 56 SFT) Manufacturing and providing Lockers front shutter with lock consist of Alnoor MDF Supper Gloss 2027 or of approved colour, complete in all aspects.</p> <p>Height 6.6 feet width 10 feet (excluding 1.6 feet space of water</p>	1	88500	88500

MEMBER
CENTRAL PURCHASE COMMITTEE
INSTITUTE OF BUSINESS ADMINISTRATION
Karachi
Syed Akbar Kazim
IBA, Karachi

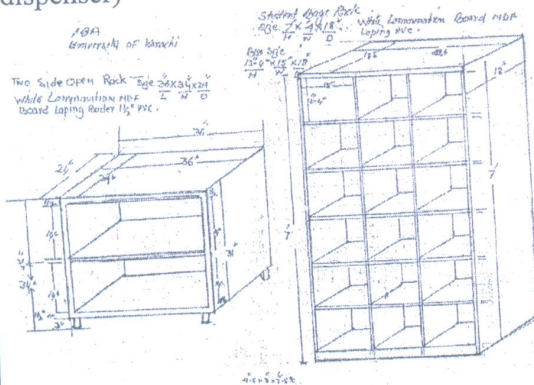

dispenser)

**CORIAN FIXING - EXTRA WORK (area - 52 SFT)****Counter & Reception**

- 8 Manufacturing and providing Counter & Reception consist of
 9 Alnoor or equivalent MDF Supper Gloss 2001 – side tables and
 3096 - central table or of approved colour, complete in all
 aspects.

side table 2'-0" x 4'-0" x 2'-6" (area – 20)

side table 2'-0" x 4'-0" x 2'-6" (area – 20)

central table 6'-6" x 2'-6" (area - 16.25)

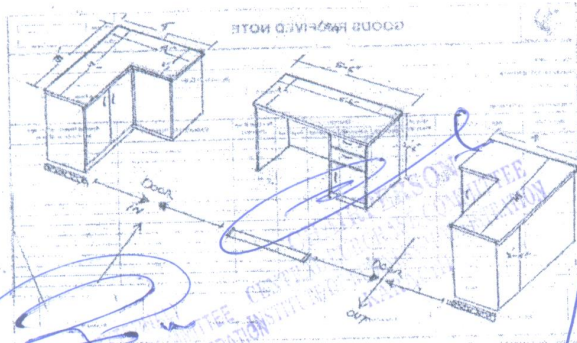

Total

845300/

17% GST

143704/

Total Amount

989,001/.

Total Amount Rupees (in words)

Nine Lac Eighty Nine thousand and
 one Rupee only

Stamp & Signature